

Copyright of this drawing is vested in Williams Ross Architects and the drawing shall not be reproduced or copied in whole or in part, in any form, without the prior written approval of Williams Ross Architects.

Suite 1, 70 Kerr Street
Fitzroy Victoria 3065 Australia
T 61 3 9416 3044
F 61 3 9416 3232
www.williamross.com

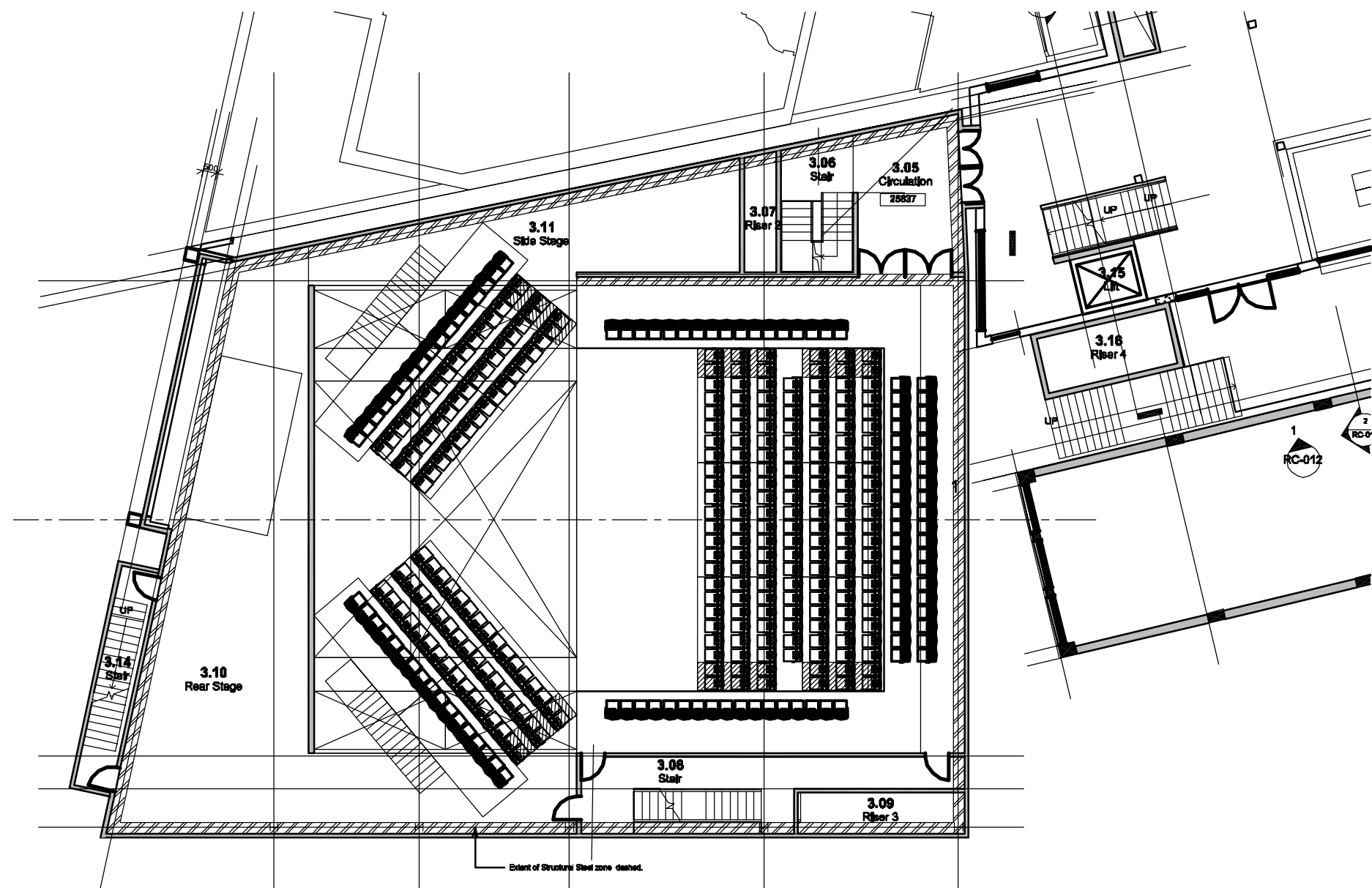
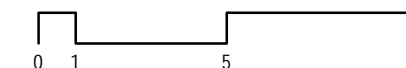
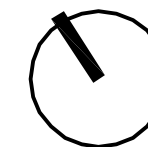

PENTAGON

| | |
|---------------------|---|
| Stalls: | 140 Seats (20 seats x 7 rows each side) |
| Angled Stalls: | 84 Seats (14 seats x 3 rows each side) |
| Gallery 1: | 74 Seats (2 rows rear / 1 row sides) |
| Angled Gallery 1: | 34 Seats (1 row each side) |
| Gallery 2: | 74 Seats (2 rows rear / 1 row sides) |
| TOTAL SEATS: | 406 SEATS |

950mm Row width generally
1050mm Aisle width generally (2 Seats)

Cheshire

williams ross architects

Q Theatre 305 Queens Street, Auckland

Seating Layouts

Pentagon

July 2007
Scale 1:200@A3
0641

SK-WR-34 A