



FUNCTIONS AT CITIZEN Q

**A CHIC SPACE AND EXPERIENCED
TEAM IN THE HEART OF THE CITY.**

By choosing Citizen Q for your next event you support Q Theatre and the independant artists that work with us.

WELCOME TO CITIZEN Q

Q's main entrance leads you straight from Queen Street into **Citizen Q**. Our fully licensed bar and kitchen is a fantastic starting point for a night out in the city centre.

Our building fuses heritage with contemporary design with a modern and relaxed environment. Original 1920's cornices are set off by rich magenta walls and polished wooden floors.

Large or small, **Citizen Q** is the perfect event space right in the heart of the Auckland arts precinct. 100% of profits generated by **Citizen Q** goes towards supporting what happens on our stages.

CONTENTS

Floor Plan	3
Gallery	4
Menus	5
Catering	7
FAQs	8
Terms and Conditions	9

MAKE AN ENQUIRY

Jesse Wikiriwhi | Jesse@qtheatre.co.nz

Visitor Experience Manager
Kaiwhakahaere Wheako Manuhiri

FLOOR PLAN

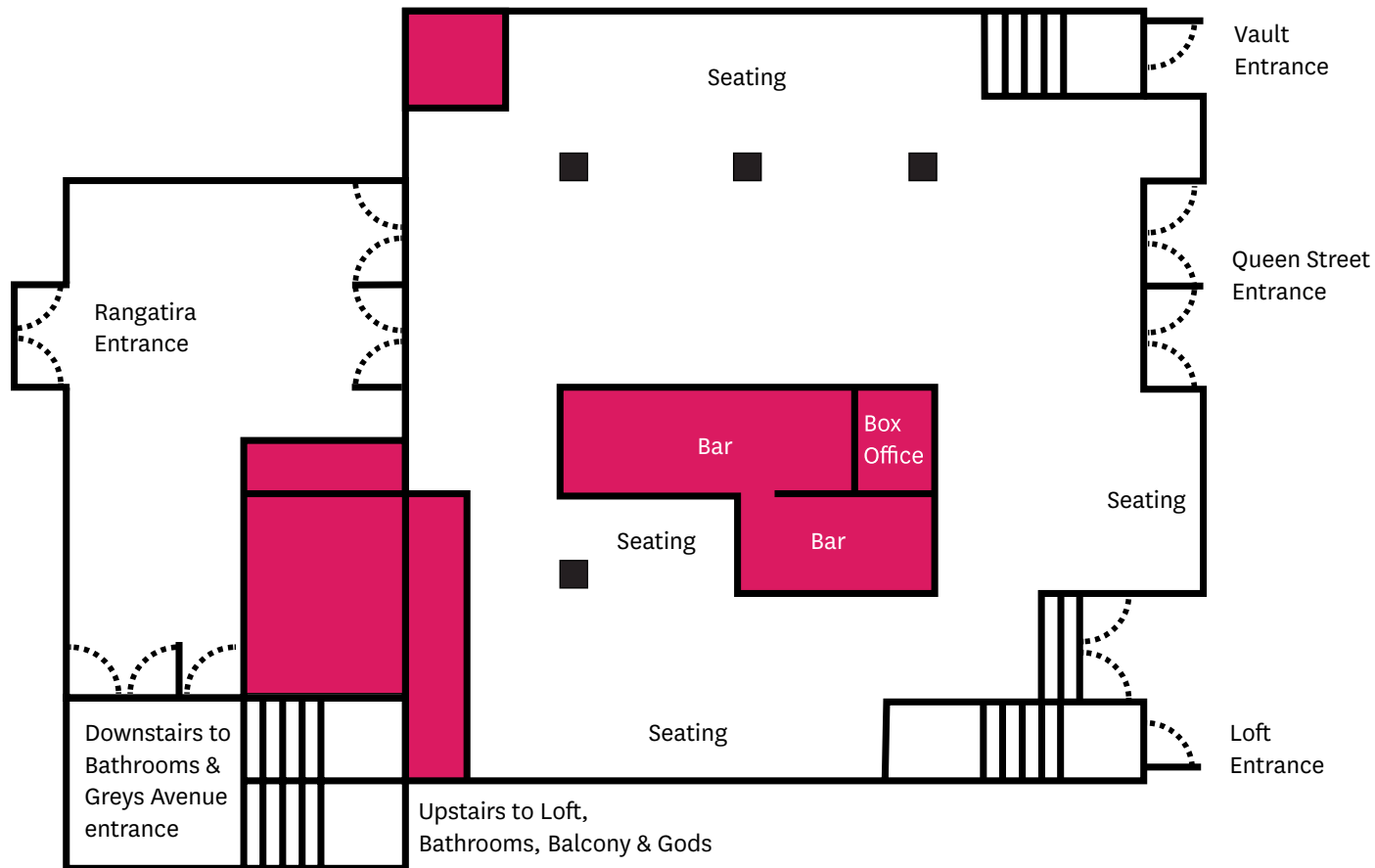

Segments of the space can be reserved for private hire by small to medium groups.

Capacity

Groups of 5 to 300

Dimensions

22m x 8m (Height varies)

Venue Hire

Subject to availability. Minimum bar spend may apply.



DRINKS MENU

White Wine

150ml / 250ml (selected varieties) / bottle

Jacob's Creek Prosecco NV - 11.5/55

Deutz Prestige Cuvée, Marlborough '15 - 14.5/70

Mumm Cordon Rouge NV - 90

Square Mile Chardonnay, Barossa '18 - 10/16.5/47.5

Mills Reef Reserve Chardonnay, East Coast '17 - 12.5/60

Church Road Chardonnay, Hawke's Bay '18 - 65 (bottle only)

Square Mile Sauvignon Blanc, Barossa '19 - 10/16.5/47.5

Catalina Sounds Sauvignon Blanc, Marlborough '20 (vegan) - 12.5/60

Square Mile Pinot Gris, Barossa '19 - 10/16.5/47.5

Spy Valley Pinot Gris, Marlborough '19 - 12.5/60

Church Road 'Gwen' Pinot Gris, Hawke's Bay '19 - 65 (bottle only)

Good Company Pinot Gris Rosé, Marlborough '18 (vegan) - 11.5/18.5/55

Red Wine

Square Mile Pinot Noir, Waipara '18 - 10/16.5/47.5

Gibbston Valley Gold River Pinot Noir, Central Otago '18 - 13.5/65

Church Road Merlot Cabernet Sauvignon, Hawke's Bay '18 - 12.5/60

The Last Shepherd Syrah, Hawke's Bay '17 - 13.5/65

Campo Viejo Tempranillo, Spain '16 - 13.5/65

Tap Beer

Monteith's Wayfarer Pilsner - 11

Tiger - 12

Bottled Beer

Heineken, Garage Project Fugazi 2.2%, Peroni Libera Zero, Pacifico - 9

Tuatara Hazy Pale Ale, Liberty Halo Pilsner - 10

Orchard Thieves Apple Cider - 10,

Panhead Supercharged APA - 11

Non Alcoholic

Juicy Lucy juice range - 5

Coke, Coke No Sugar, lemonade, ginger ale, tonic water, soda water - 5

Otakiri still or sparkling water - 5

All Good Organics range - 5

Bundaberg Ginger Beer - 6

Red Bull, Red Bull Sugar Free - 6

A full range of spirits is available from the bar

CATERING

Q Theatre is proud to partner with **Urban Gourmet** to deliver an exceptional catering experience.

Whether you are catering for a small gathering or a gala awards dinner, Urban Gourmet caters to your every need.

Their professional and friendly team are on hand to ensure all your catering expectations are exceeded.

Catering proposals are available upon request.

Q Theatre also provides some in-house catering options for those smaller gatherings and hostings.

Get in touch for more information on how we can best service your catering needs.

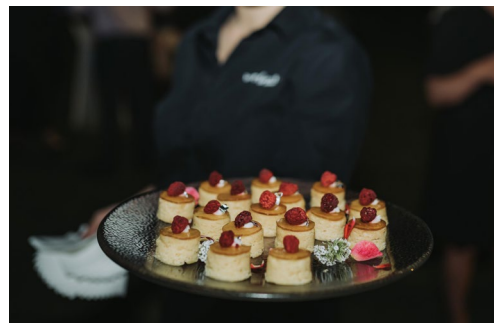

FREQUENTLY ASKED QUESTIONS

Can I hire Citizen Q exclusively for my event?

Citizen Q is **Q Theatre's** main bar for patrons attending performances or events within the building. For this reason, exclusive hire is only available when there are no other performances or events happening in the building.

Is there a minimum bar spend required when I hire Citizen Q exclusively?

If you are hiring **Citizen Q** exclusively, yes. The minimum bar spend is \$1,500.

Do you charge a venue hire fee for exclusive use?

For **Citizen Q**, no. However the minimum bar spend will apply in this instance.

Am I able to host a group of people for an event without exclusively hiring Citizen Q?

Absolutely. If we are open for business you are more than welcome. It's always best to get in touch first to make sure we have the room and to discuss what your needs are.

I want to give a presentation and may require some technical elements i.e. staging, PA system, DJ, projection. Is this possible?

Definitely. Our technical team are ready to help with all your technical requirements. There will be costs associated with any of these requests which we are happy to provide you with a quote.

Am I able to hire other areas of the building as well as Citizen Q?

You sure can. Our Programme Manager is on hand to provide you with all the information you need. Just to note again, **Citizen Q** may not be available exclusively if we have other events happening in the building.

I want to provide catering for my event, is this something you provide?

We currently work with Urban Gourmet to provide catering for most of our large events. If you let us know what you are after, we can get a proposal put together for you.

We also have our own kitchen in house that offers a small range of small plates and nibbles.

TERMS AND CONDITIONS

A 50% deposit of the minimum bar spend is required to secure your booking.

A credit card must be provided to secure the reservation and will be held on the night/day of booking.

Once a booking is confirmed, cancellation of the event within 48 hours will result in loss of your 50% deposit plus any incurred costs relating to the event e.g. speciality ordered stock, hireage of equipment. Payment must be made in full on the day of hire unless otherwise arranged.

Minimum bar spend applies to beverage only. If the minimum bar spend is not met, the difference must be paid by the hirer.

Hirer acknowledges that all decisions relating to the sale or supply of alcohol during the event are at Q's sole discretion.

Hirer will comply and ensure that all Persons under Hirer's Control comply with all conditions and requirements of Q

alcohol and other applicable licences.

Q will adhere to the latest New Zealand Government's COVID-19 Alert System's rules and restrictions: <https://COVID19.govt.nz/>

Any breakages or damages to the venue will be charged to the hirer.

We have preferred catering suppliers for Q. However, we are happy to discuss alternative options.

Security may be required to be on site dependent on the nature of the event. If security is needed, the hirer will be required to cover these costs.

For evening events, bar service ends no later than 11:30pm with the venue closing by midnight.





FUNCTIONS AT CITIZEN Q

A chic space and experienced team in the heart of the city.
